

Kits  
**KA709 - PP206**  
**KA710**

Finished  
 .45 caliber percussion  
 .45 caliber flintlock

**Discontinued (1975 - 1988)**  
**Discontinued (1975 - 1984)**

# KENTUCKY PISTOL & KIT

## SCHEMATIC

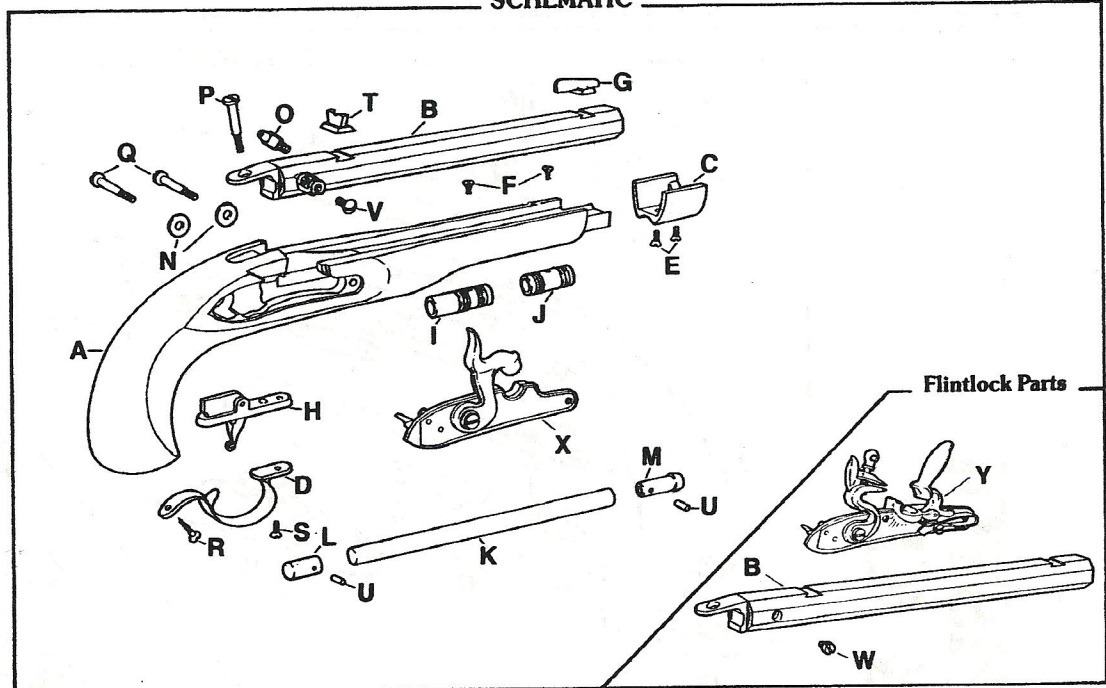

## PARTS

Letter	Description	Number
A	Stock	11100
B	Barrel Assembly .45 caliber percussion .45 caliber flintlock	11200 11210
C	Nose Cap	11300
D	Trigger Guard	11310
E	Nose Cap Screw (2)	11400
F	Thimble Screw (2)	11410
G	Front Sight Assembly	11510
H	Trigger Assembly	11521
I	Rear Thimble	11530
J	Front Thimble	11540
K	Ramrod	11550
L	Ramrod Rear Tip	11560
M	Ramrod Front Tip	11570
N	Lock Washer (2)	10317
O	Nipple-percussion only	10401
P	Tang Screw	10410
Q	Lock Washer Screw (2)	10420
R	Rear Trigger Guard Screw	10430
S	Front Trigger Guard Screw	10440
T	Rear Sight	10500
U	Ramrod Pin (2)	10550
V	Bolster Screw - percussion only	12540
W	Flash Hole Liner - flintlock only	10450
X	Lock - percussion	LK1313A
Y	Lock - flintlock	LK1314A

\*Barrel Assembly includes: breech plug and percussion or flintlock bolster...NOT sold separately.