

<b>KA715 - PR405</b>	.45 caliber percussion	<b>Discontinued (1976 - 1985)</b>
<b>KA716 - PR406</b>	.50 caliber percussion	<b>Discontinued (1976 - 1985)</b>
<b>KA717 - FR507</b>	.45 caliber flintlock	<b>Discontinued (1976 - 1985)</b>
<b>KA718 - FR508</b>	.50 caliber flintlock	<b>Discontinued (1976 - 1985)</b>

# MOUNTAIN RIFLE & KIT

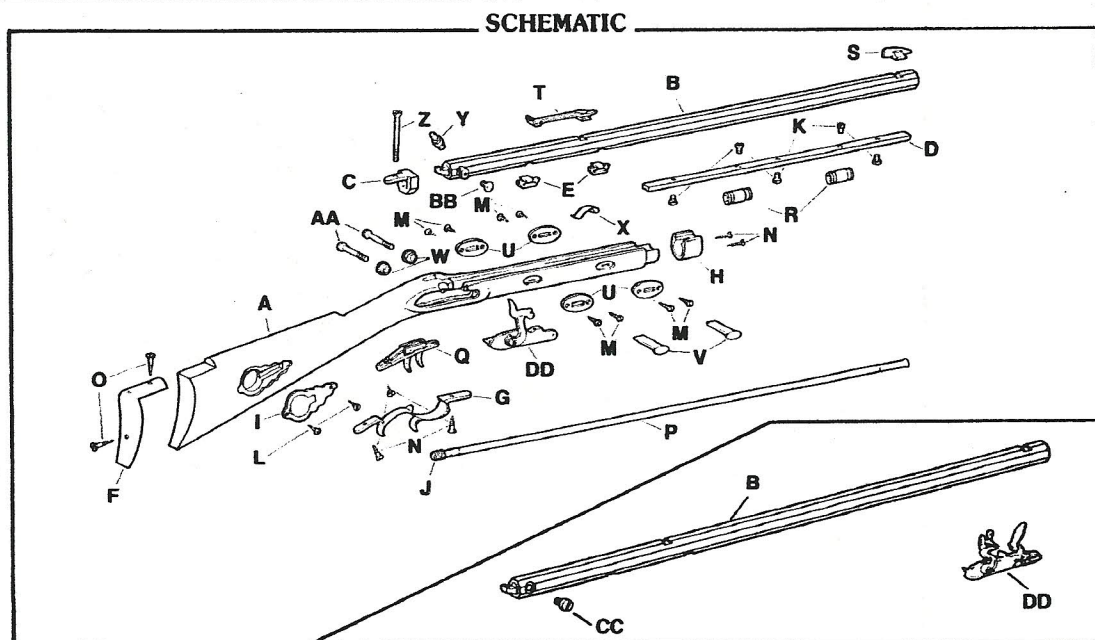

**PARTS**

Letter	Description	Number
A	Stock	16100
B	Barrel Assembly*	
	.45 caliber percussion	16200
	.50 caliber percussion	16206
	.45 caliber flintlock	16250
	.50 caliber flintlock	16260
C	Tang	16220
D	Barrel Rib	16230
E	Barrel Tenon (2)	16240
F	Butt Plate	16300
G	Trigger Guard	16310
H	Nose Cap	16320
I	Patchbox	16390
J	Jag - .45 caliber	16401
	.50 caliber	16402
K	Rib & Thimble Screw (5)	16410
L	Patchbox Screw (2)	16420
M	Wedge Plate Screw (8)	16430
N	Nose Cap, Trigger Guard & Trigger Plate Screw (5)	16440
O	Butt Plate Screw (2)	16450
P	Ramrod Assembly	16500
Q	Double Set Trigger Assembly	16510
R	Thimble (2)	16520
S	Front Sight Assembly	16530
T	Rear Sight Assembly	16540
U	Wedge Plate (4)	16560
V	Wedge (2)	16570
W	Lock Washer (2)	16580
X	Ramrod Retaining Spring	16591
Y	Nipple - percussion only	10400
Z	Tang Screw	10410
AA	Lock Washer Screw (2)	10491
BB	Bolster Screw - percussion only	10520
	flintlock only	10450
DD	Lock - percussion	LK1321A
	flintlock	LK1322A

\*Barrel Assembly includes: breech plug and percussion or flintlock bolster...NOT sold separately.