

RV620 .36 caliber - steel frame
 RV622 .44 caliber - brass frame
 RV625 .44 caliber - steel frame

Kits

KA621 Discontinued
KA623

1861 COLT NAVY REVOLVER & KIT

SCHEMATIC

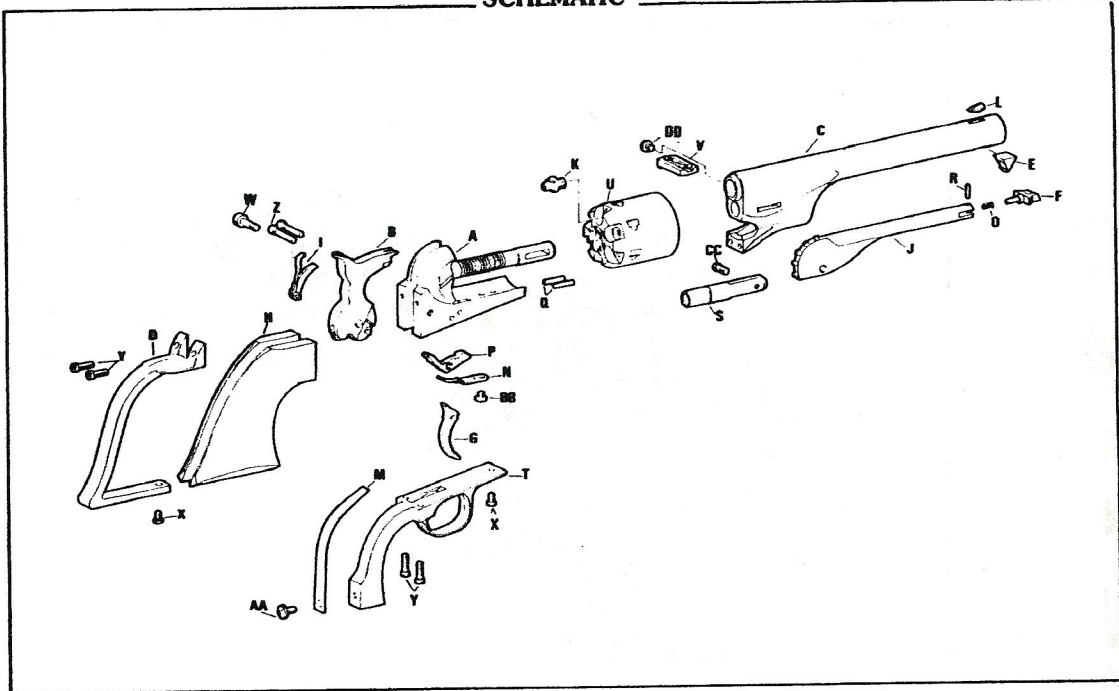

PARTS

Letter	Description	.36 caliber steel frame		.44 caliber brass frame	
		Number	Retail Price	Number	
A	Frame Assembly (steel)	618020	\$55.00	617020	
	(brass)	616020	40.00	617025	
B	Hammer Assembly	616030	8.00	616030	
C	Barrel	618040	50.00	617040	
D	Backstrap	616050	15.00	616050	
E	Loading Lever Retainer	617060	3.00	617060	
F	Loading Lever Latch	616070	3.00	616070	
G	Trigger	616100	3.00	616100	
H	Grip	616110	15.00	616110	
I	Hand and Spring Assembly	616120	4.00	616120	
J	Loading Lever	617130	14.00	617130	
K	Nipple (6)	617140	1.75 ea.	617140	
L	Front Sight	617150	2.00	617150	
M	Mainspring	616160	1.50	616160	
N	Trigger and Bolt Return Spring	616170	.75	616170	
O	Latch Spring	616190	.50	616190	
P	Bolt	616210	4.50	616210	
Q	Base Pin (2)	616230	.50 ea.	616230	
R	Latch Retaining Pin	616240	.50	616240	
S	Loading Plunger	618260	4.00	617260	
T	Trigger Guard	616270	18.00	616270	
U	Cylinder	616300	22.00	617300	
V	Barrel Wedge Assembly	616310	2.75	616310	
W	Hammer Assembly Screw	616330	.50	616330	
X	Bottom Backstrap & Front Trigger Guard Screw (2)	616340	.50 ea.	616340	
Y	Top Backstrap & Rear Trigger Guard Screw (4)	616350	.50 ea.	616350	
Z	Trigger and Bolt Screw (2)	616360	.50 ea.	616360	
AA	Mainspring Screw	616380	.50	616380	
BB	Trigger and Bolt Spring Screw	616390	.50	616390	
CC	Loading Lever Screw	617400	.50	617400	
DD	Barrel Wedge Screw	616430	.50	616430	